

## Rosedale Campus Manager v 1.2

**All Campuses page:** Shows course timelines from all campuses. Note that the “Sort by” dropdown menu (see red arrows) sorts information by Campus, Department, Course and Teacher. The other dropdown menus allow for more granular filtering of courses.

The screenshot displays the 'All campuses' page in the Rosedale Campus Manager v 1.2. The interface is divided into several sections:

- Sidebar:** Contains navigation links for 'All campuses', 'Campus 1', 'Campus 2', and 'Campus 3'. Below these are links for 'Timeline', 'Calendar', 'Milestones', 'Tasks', 'Bugs', 'Files', and 'Discussion'.
- Top Navigation Bar:** Includes a 'demo Administrator' profile, a 'Sort by' dropdown menu (highlighted with a red arrow), and several filter dropdowns: 'Show all campuses' (Campus A, B, C), 'Show all courses' (Only courses in progress, Only completed courses, Only upcoming courses), 'All departments' (Math, Business, Science, English), 'All teachers' (Teacher 1, 2, 3), 'All countries' (Canada, Brazil, China, Niigra), 'Start date', and 'End date'.
- Main Content Area:** Displays course timelines for three campuses. The timeline is organized by month (December and January) and shows the duration of courses for each campus. The courses are listed in a table below the timeline.

**Sort by dropdown menu (highlighted with a red arrow):**

- Sort by Campus
- Sort by Department
- Sort by Course
- Sort by Teacher

**Filter dropdowns (highlighted with red arrows):**

- Show all campuses: Campus A, Campus B, Campus C
- Show all courses: Only courses in progress, Only completed courses, Only upcoming courses
- All departments: Math, Business, Science, English
- All teachers: Teacher 1, Teacher 2, Teacher 3
- All countries: Canada, Brazil, China, Niigra
- Start date: [calendar icon]
- End date: [calendar icon]

**Course Timelines:**

Campus	Course	Students	School Days
Campus A	Course 1	23 students	55 school days
Campus A	Course 3	18 students	67 school days
Campus B	Course 1	13 students	20 school days
Campus B	Course 2	14 students	87 school days
Campus B	Course 3	28 students	67 school days

**Sort by Department (highlighted with a red arrow):**

- Math
- Science
- English

**Sort by course (highlighted with a red arrow):**

- Course 1
- Course 2
- Course 3

**Sort by Teacher (highlighted with a red arrow):**

- Teacher 1
- Teacher 2
- Teacher 3

**Single campus page:** This page shows information about a single campus. Note that courses can be added, deleted and edited on the Course Calendar section. I assume it makes sense to treat each UpStream “Project” as a Campus.

demo Administrator

All campuses

Campus 1

Timeline

Calendar

Milestones

Tasks

Bugs

Files

Discussion

Campus 2

Campus 3

Campus 1 In Progress

Campus Details

A. Campus name: (text field - This is the “project”, as defined by UpStream)

B. Campus number: (auto-generated number)

C. Number of students: (text box – number only)

D. Campus timetable: (file upload)

E. Location (city, state/province, country)

F. Partnership start: (date sector)

G. Type: (dropdown: High school, Learning Centre, Other)

H. Description: (text box)

I. Campus performance: (dropdown: Critical, Poor, Average, Very good, Excellent)

J. Private notes: (can only be seen by *Rosedale Staff-Toronto* role – maybe use bug tracker for this?)

User Info (modal window)

1. First name: textbox
2. Last name: textbox
3. English name: textbox
4. Birthdate: date picker
5. Birthplace: city, province, country
6. Nationality: textbox
7. Flag: Options: Options: None, Needs special attention
8. Notes: text box
9. Roles: Options: Select from list
10. Status: Options: Active, Graduated, Suspended, Pending, Other
11. Campus: None, Select from list

Campus Staff

Campus Teachers

Teacher 1

Teacher 3

Campus Admin.

Campus Admin 2

Campus

Te

Campus Classes

Class ID	Course	Start date	End date	students	Classroom Teacher	Teacher Assistant	Online Teacher	Note
A101	ENG3U	16/01/2019	01/03/2019	14	Beth Jones	Sam Buntu	Keri Wonka	
A102	MAT4M	13/03/2019	01/05/2019	14	Willa Mona	Zia Greta	Frank Jones	

Edit

Delete

Edit

Delete

Add new class..

Can we use Milestones as Courses? See next page.

COURSES are predefined, which means they are the same for all campuses (example: ENG3U, MAT4M). CLASSES are just local iterations of courses, which means that they have a start and end date. Campus 1 and Campus 2 could both run the ENG3U course, but their classes would have different start/end dates. From what I can tell by the Milestones interface, we may be able to use it to represent courses if we could replace the “assigned to” field with 3 pre-defined roles, as shown here:

Before

New: Milestone

Milestone

Assigned To

Start Date

End Date

Reminders

Notes

Cancel

Save

After

New: Milestone Class

Class ID: A235

Course Milestone

ENG3U - English 12

Online Teacher Assigned To

Campus Teacher Assigned To

Teacher Assistant Assigned To

Start Date

End Date

Reminders

Notes

Cancel

Save

User profiles, user roles, campus profiles and courses will be managed in a separate WordPress plugin. Upstream will use this data.

User profiles	Roles	Campus profiles	Courses
1. First name: textbox 2. Last name: textbox 3. English name: textbox 4. Birthdate: date picker 5. Birthplace: city, province, country 6. Nationality: textbox 7. Flag: Options: Options: None, Needs special attention 8. Notes: text box 9. Roles: Options: Select from list 10. Status: Options: Active, Graduated, Suspended, Pending, Other 11. Campus: None, Select from list	<ul style="list-style-type: none"> <li>• Program manager</li> <li>• Online teacher</li> <li>• Rosedale staff – Toronto</li> <li>• Rosedale staff – China</li> <li>• Campus Teacher</li> <li>• Campus Teacher Assistant</li> <li>• Campus Supervisor</li> <li>• Campus Admin</li> <li>• Campus POC</li> <li>• Campus Other</li> <li>• Rosedale employee</li> <li>• Campus employee</li> </ul>	A. Campus name: (text field - This is the “project”, as defined by UpStream) B. Campus number: (auto-generated number) C. Number of students: (text box – number only) D. Campus timetable: (image upload) E. Location (city, state/province, country) F. Partnership start: (date sector) G. Type: (dropdown: High school, Learning Centre, Other) H. Description: (text box) I. Campus performance: (dropdown: Critical, Poor, Average, Very good, Excellent) J. Private notes: (can only be seen by <i>Rosedale Staff-Toronto</i> role – maybe use bug tracker for this?)	Department 1 <ul style="list-style-type: none"> <li>• ENG3U</li> <li>• ENG4U</li> </ul> Department 2 <ul style="list-style-type: none"> <li>• MFT3U</li> <li>• MT4</li> </ul> Department 3 <ul style="list-style-type: none"> <li>• SPN3U</li> <li>• SNC3U</li> </ul>

UpStream will manage courses, as shown below and on page 2 above.

<ul style="list-style-type: none"> <li>• Class ID: (auto-generated and unique)</li> <li>• Course Code:</li> <li>• Start date:</li> <li>• End date:</li> <li>• Number of students:</li> <li>• Campus Teacher: (select form list of campus teachers in this campus)</li> <li>• Campus Teacher Assistant: (select from list of Campus Teacher Assistants in this campus)</li> <li>• Online Teacher: (select from list of Online Teachers)</li> </ul>
---

Campus Classes:

Class ID	Course	Start date	End date	students	Classroom Teacher	Teacher Assistant	Online Teacher	Note
A101	ENG3U	16/01/2019	01/03/2019	14	Beth Jones	Sam Buntu	Keri Wonka	
A102	MAT4M	13/03/2019	01/05/2019	14	Willa Mona	Zia Greta	Frank Jones	

Other features:

1. Show small modal/tooltip when class is clicked

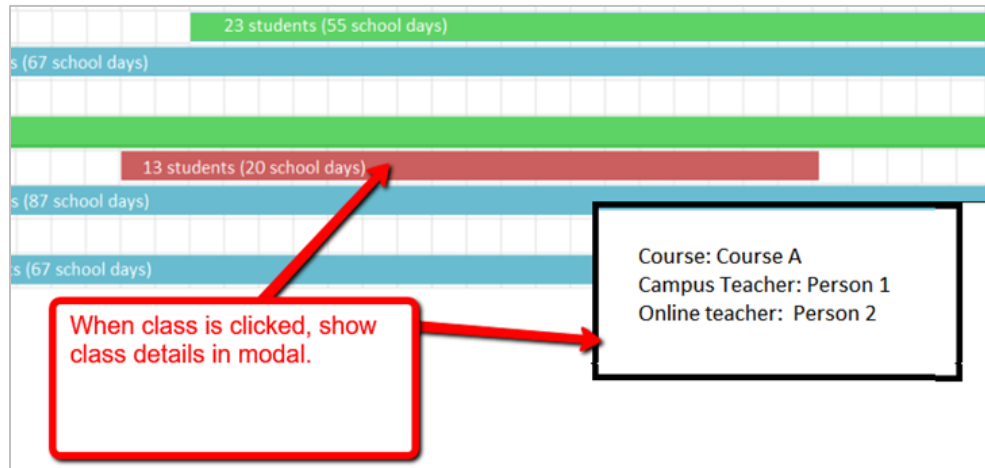

2. Campus profiles use country dropdown to set location. In Timeline view, campuses can be filtered by country.

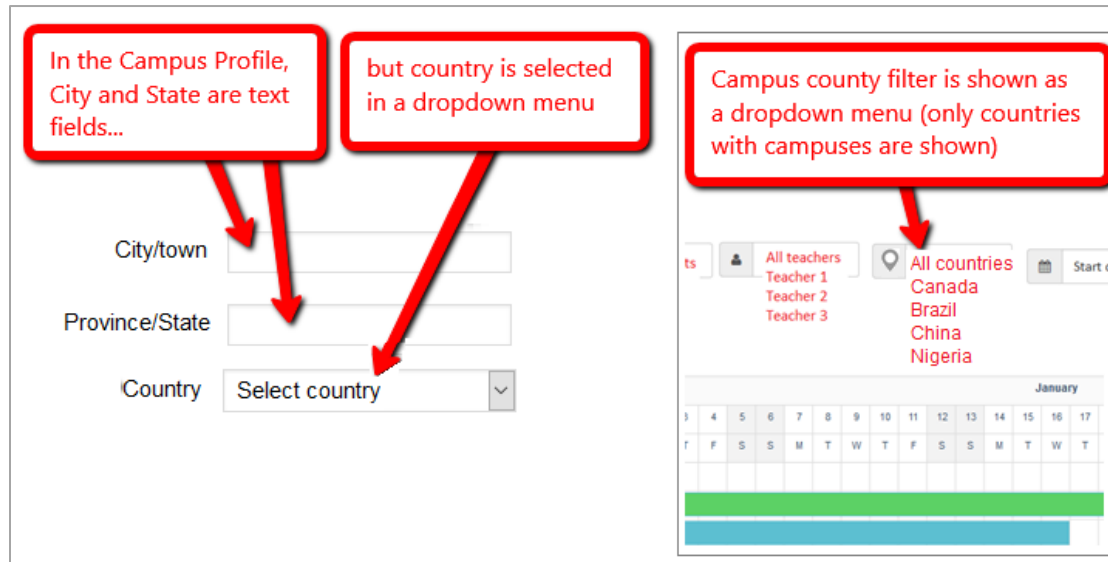

3. Each class should have a unique ID

Class ID is autogenerated and unique. Format is not important but ideally it should be short and easy to remember

Campus Classes:

Class ID	Course	Start date	End date	stude
A101	ENG3U	16/01/2019	01/03/2019	14
A102	MAT4M	13/03/2019	01/05/2019	14